

6. Adjusting the cord length and fitting the tension pulley

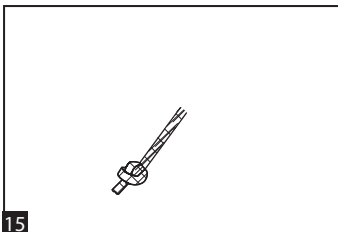

1. Go to the masterside with the knotted cord ends and pull down on the right hand knot to reduce the cord loop. (Fig. 15)

To prevent the risk of child strangulation the cord loop must be a maximum of 1m from the rail and the tension pulley must be fitted.

NOTE: it's the responsibility of the person fitting the rail to ensure that the cord length meets the stated requirements.

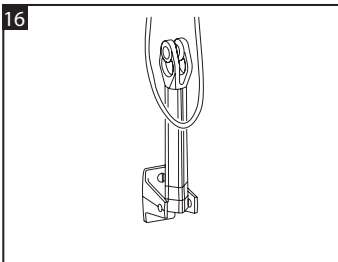

Using the two screws supplied, fix the tension pulley at the correct height, directly in line with the pull cord as shown (Fig. 14).

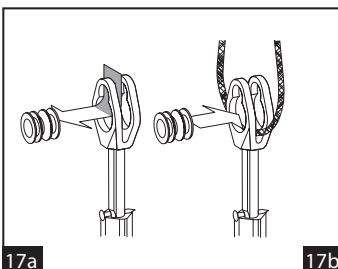

2. Extend the neck of the pulley and secure in higher position using a pin or small nail. Remove the central barrel of the pulley by pulling it down and then out (Fig. 17a). Place the cord inside the pulley and replace the barrel ensuring it clicks into place (Fig. 17b).

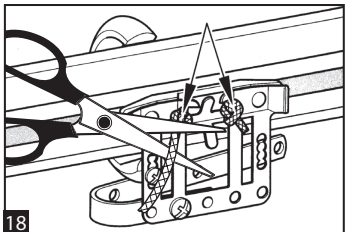

3. Take up the slack of the cord and tie a knot behind the masterside arm. Remove the pin or nail from the pulley, the cord will now be fully tensioned. If there is insufficient tension in the cord, reduce the cord length by adjusting the knot behind the masterside arm (Fig. 18). Cut the excess cord in front of the knot.

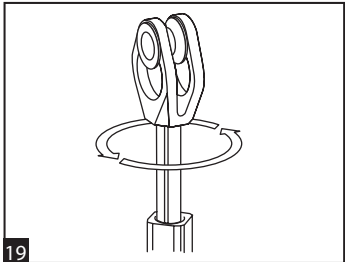

4. If the cord becomes twisted, simply rotate the head of the pulley to untwist it (Fig. 19). The track is now ready to accept curtains.



WARNING



It is essential that these instructions are followed to ensure the product works correctly and to prevent the risk of young children becoming entangled in the cord loop. If in doubt consult a professional fitter for advice.

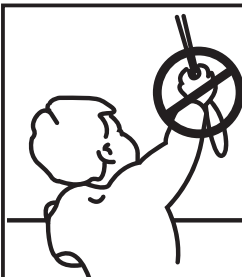

WARNING

Young children have been strangled by loops in pull cords, chains, tapes and inner cords that operate the product.

To avoid strangulation and entanglement, keep cords out of the reach of young children.

Cords may become wrapped around a child's neck.

Move beds, cots and furniture away from window covering cords.

Do not tie cords together.

Make sure cords do not twist and create a loop.

PERSONS IN CHARGE OF CHILDREN ARE ULTIMATELY RESPONSIBLE FOR FOLLOWING THE SAFETY INSTRUCTIONS PROVIDED BY THE MANUFACTURER AND TO USE ANY SAFETY DEVICE SUPPLIED.

The installation can be completed by non-professionals.

Safety

- Only use a step ladder or stable chair to reach fixing height.
- Do not over reach. Always move the step ladder or chair so that you are in a safe working position.
- Do not hold or lean on the track to support your weight.
- Use two people for the installation of longer tracks.
- Take care when using power tools, use of a Residual Current Device (RCD) is recommended.
- Always wear eye protection when drilling.
- Beware of hidden pipe runs and cables.

Royal Orb Curtain Pole

Fitting Instructions

Please read these instructions carefully and check the contents of the pack against the table below before attempting to assemble and fix this product. The fixing screws supplied are for use where a wooden batten is fixed to the wall. If you intend to fix the track directly to the wall, you must use the most appropriate wall plugs and fixings.

Tools Required: Spirit level, Tape measure, Flat bladed screw driver, Crosshead (Phillips) screwdriver, 2mm drill bit (pilot hole for wood screws), 6mm drill bit for fixing batten or track to wall (if required), Pencil, Stepladder.

Please ensure the correct wall plugs are used to suit your wall type.

The finial may vary from that shown.

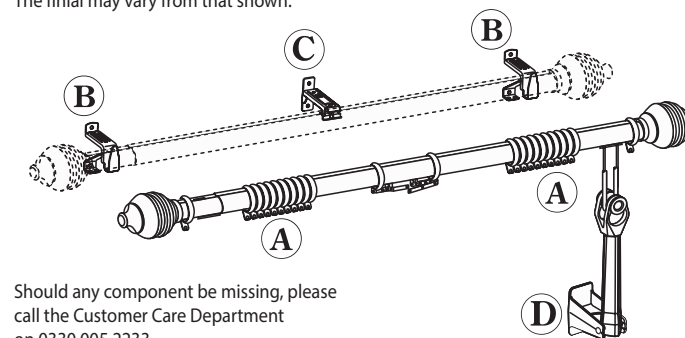

Should any component be missing, please call the Customer Care Department on 0330 005 2233.

Contents ▾ Lengths (m) ▷	0.96m - 1.68m	1.68m - 3.05m	2.13m - 3.96m
A Ring slides	16	26	32
B End brackets (inc. screws)	2	2	2
C Intermediate supports	1	2	3
D Tension Pulley	1	1	1

1. Preparing the window

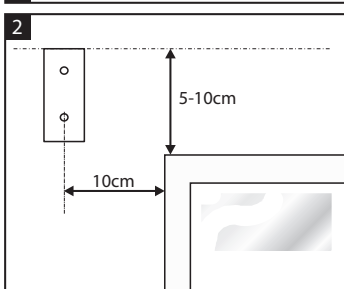
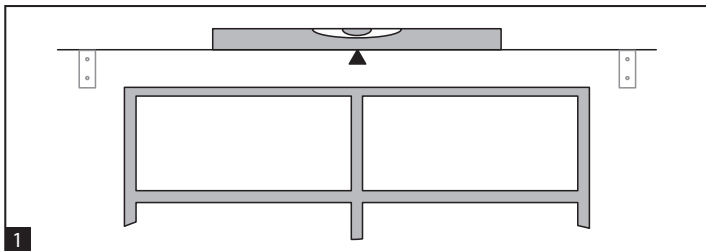

Use a spirit level to mark the top line of the brackets, Fig. 1. The pole must be fitted at least 1.5m from the floor.

Position pole up to the window and centralise over width to determine correct length, Fig. 2. Remember to allow sufficient length either side to accommodate the curtains when opened and the finials when fitted.

For long pole lengths you must fit intermediate support brackets at equal intervals along the pole length shown in Fig. 3.

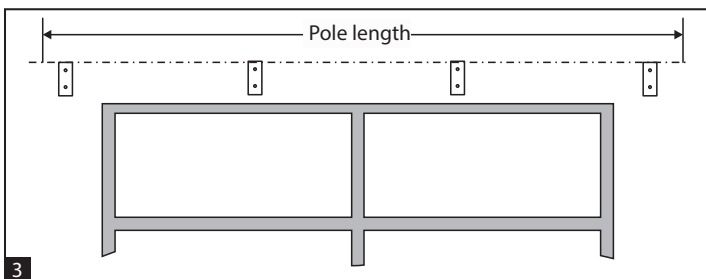

The pole is adjusted in length by sliding the inner pole into or out of the outer pole.

2. Fixing wall brackets

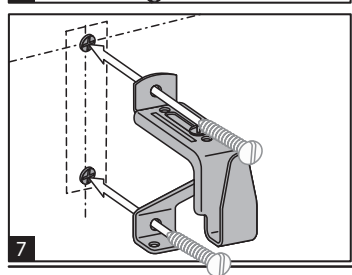
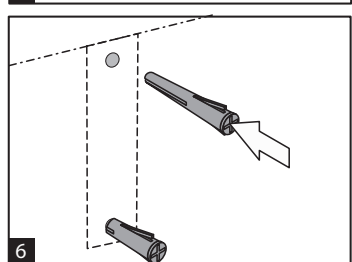
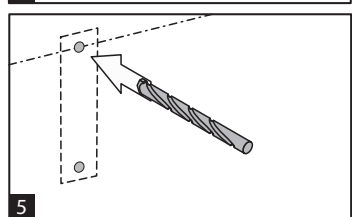
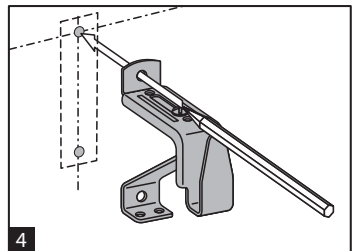

1. Position the brackets on the wall and mark the holes on the wall, Fig. 4.

2. Drill 2mm Ø pilot hole if mounting on to a wooden batten. If mounting directly on to a masonry or studded wall, Fig. 5, use the appropriate drill size (seek guidance from local builder's store if unsure).

Please ensure the correct wall plugs are used to suit your wall type.

3. If mounting directly onto a masonry or studded wall insert suitable wall plugs, Fig. 6.

4. Using the correct screws fix the brackets securely, Fig. 7.

5. Repeat for all the brackets required.

3. Fitting the pole

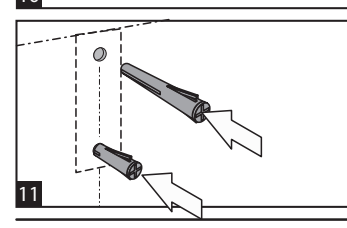
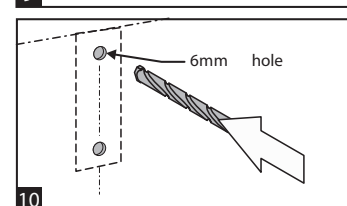
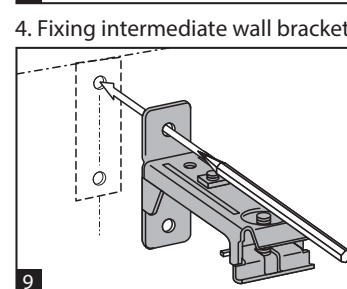
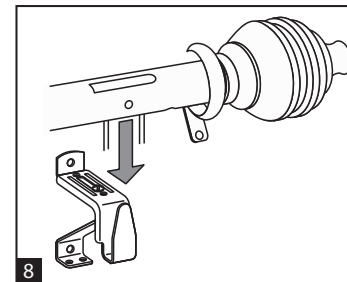

1. Extend pole to the approximate required length, slide one curtain ring to each end of the pole (next to finials) and place pole onto the wall brackets. At each end of the pole there is a small hole on the underside. These holes locate on the protruding lugs in each end bracket arm (Fig. 8).

1. Place the pole on the outer brackets and position the intermediate bracket and mark the holes on the wall, Fig. 9.

2. Drill 2mm Ø pilot hole if mounting on to a wooden batten or 6mm Ø if mounting directly on to a masonry or studded wall Fig. 10.

Please ensure the correct wall plugs are used to suit your wall type.

3. If mounting directly onto a masonry or studded wall insert suitable wall plugs, Fig. 11.

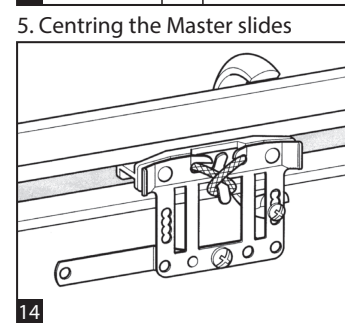
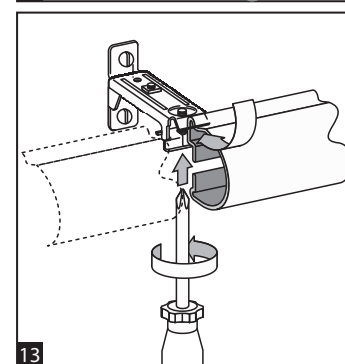
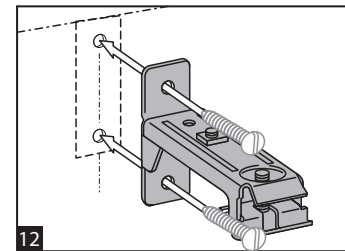

4. Using the correct screws fix the brackets securely, Fig. 12. Alternative wall fixings should be used where necessary.

5. Attach supports by hanging the clip in the channel of the pole. The bracket is extendable by loosening the small screw underneath and sliding the bracket forwards or backwards.

5. Centring the Master slides

1. Pull outer draw cord to move overlap Master Slide to its end of the rail. Holding both cords taut, move the underlap Master Slide to its end of the rail.

2. Lift the cord up off the top peg behind the left hand master slide, twist it once and place the loop created over the lower peg as shown (Fig. 14).

3. Gently pull the one cord to tighten the loop. Check to ensure the Master slides are still centred and adjust if necessary.