

# Signature Motorised Roller Blind

## Final Setup Instructions

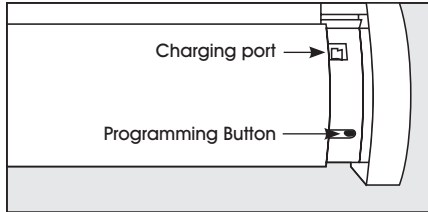

In order to ensure safe transportation of your blind we have placed the motor into SLEEP MODE. If you ordered a handset with your blind you just need to wake up the motor as in Step 1 then skip to Step 3 to fine tune your top and bottom limits if required

If you already have a handset that you wish to pair to this blind, wake up the motor as in Step 1 then pair your handset as in Step 2.



See our instructional video here on how to program your motor.

### 1 How to wake up the motor...

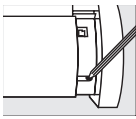

1. Using a fine tip pen, pencil or pin... Press and release the program button on the motor, this located underneath the charging port



2. The blind will jog once to confirm

### 2 How to pair your handset to the motor...

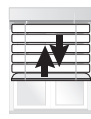
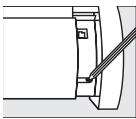

1. Press and hold the program button on the motor until... the blind jogs once



2. Choose the relevant channel that you wish to pair the blind to, you can do this by pressing the button at the bottom of your handset to cycle through the different channels indicated by the red led light. then press and release the program button on the back of the remote

### 3 How to adjust your down limit...



1. Place the blind in the **down position**



2. Press simultaneously until... motor jogs



3. Choose a new down position



4. To confirm new down position, press 'My' until motor jogs → OK

### 4 How to adjust your up limit...



1. Place the blind in the **up position**

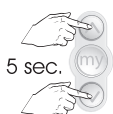

2. Press simultaneously until... motor jogs



3. Choose a new up position



4. To confirm new up position, press 'My' until motor jogs → OK

### 5 How to set 'MY' position...



1. Place the blind in the desired position

2. To confirm new 'My' position, press 'My' until motor jogs → OK

### 6 How to adjust 'MY' position...

Repeat procedure to a new desired position

### 7 How to remove programmed 'MY' position...



or



or



or



or



1. Place the blind in the my position

2. Press 'My' for 5 seconds until... motor jogs

### 8 How to add your blind to the 'ALL' Channel...

As well as being able to control your blinds individually you can add each blind you program to the ALL Channel, this allows you to raise all the blinds on this channel simultaneously.



1. Select the appropriate channel that your blind is programmed to then press and release the button on the back of the handset, the motor will jog

2. Press the button at the bottom of the handset until you get to the all the led lights are flashing as this indicates you are on the 'ALL' channel



3. Press and hold the button on the back of the handset until the motor jogs.

Your blind has now been added to the 'ALL' channel. Repeat this process for any of the other blinds you wish to add



**HALLIS HUDSON**  
*Committed to excellence*